

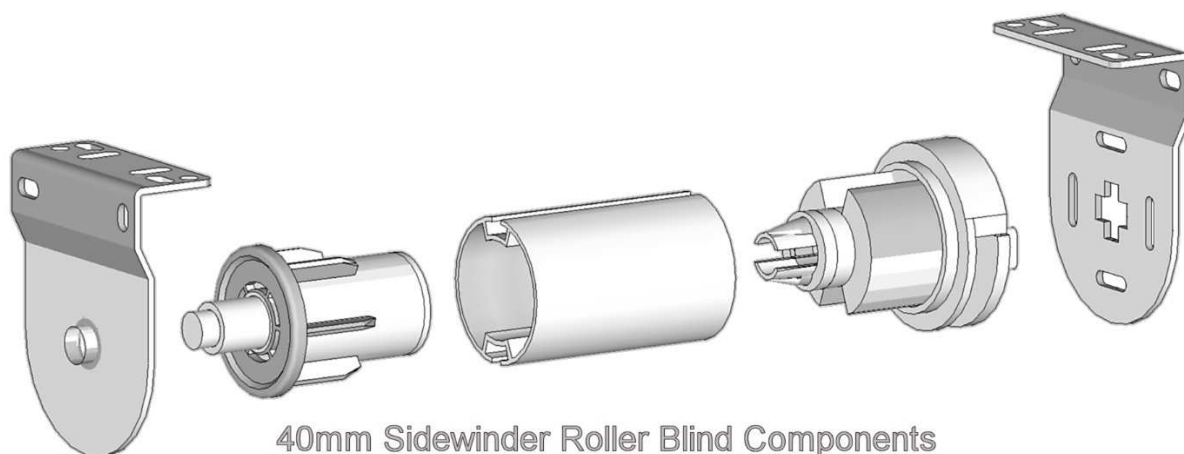

## 40 mm Sidewinder Roller Blinds

The professional quality range of sidewinder roller blinds systems that are used in all Saxon Blind's installations have been engineered to precise perfection, offering a unique balance between design, engineering and cost. Technology, insight and knowledge have been used to innovate, refine and develop a collection of reliable components ultimately suitable for any commercial applications.



40mm Sidewinder Roller Blind Components

### Drive End Features:

- Tensile spring loading mechanism manufactured in stainless steel.
- Operated with plastic or nickel N° 10 chain
- Internal mechanisms are coated with tailored lubricant ensuring smooth and quiet operation.
- 3 pin secure fitting clicks securely into bracket.
- Floating outer cover enables chain to be fitted without dismantling the clutch

### Free End:

- Spring loaded plunge pin design offers flexibility when installing blinds.

### Bracket Features:

- Load Capacity 2.75Kg
- Powder coated for rust resistance.
- Plastic cover caps available to finish blinds when fitted outside the recess.
- Extended base bracket aids installation while keeping slim profile shape.
- Extension brackets available – projection dimension 86mm

### Roller Tube:

- High Quality extruded aluminium 40mm double slot tubing with keyed fitting of the drive and free ends.

### Maximum recommended fabric sizes for blinds on 40mm roller tube system.

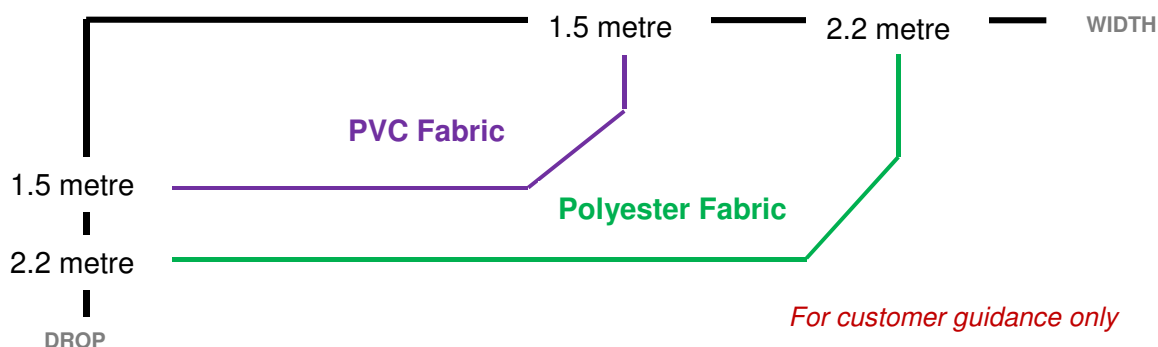



## 45 mm Sidewinder Roller Blinds

The professional quality range of sidewinder roller blinds systems that are used in all Saxon Blind's installations have been engineered to precise perfection, offering a unique balance between design, engineering and cost. Technology, insight and knowledge have been used to innovate, refine and develop a collection of reliable components ultimately suitable for any commercial applications.

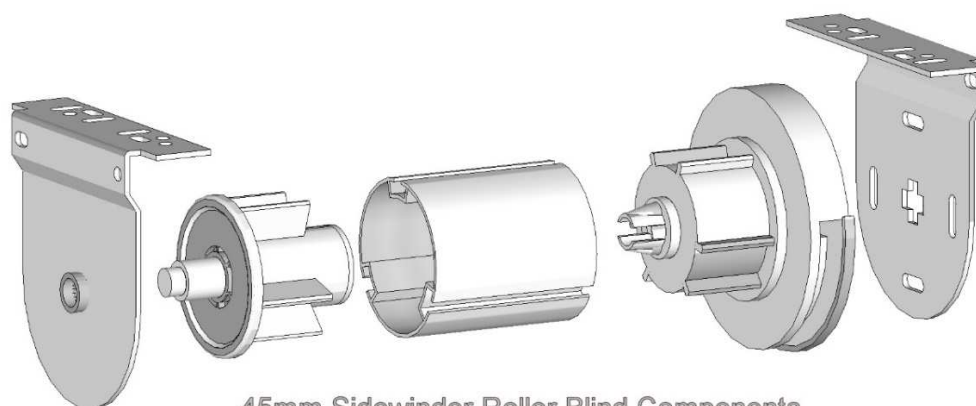

45mm Sidewinder Roller Blind Components

### Drive End Features:

- Tensile spring loading mechanism manufactured in stainless steel.
- Operated with nickel N° 10 chain
- Internal mechanisms are coated with tailored lubricant ensuring smooth and quiet operation.
- 3 pin secure fitting clicks securely into bracket.
- Floating outer cover enables chain to be fitted without dismantling the clutch

### Free End:

- Spring loaded plunge pin design offers flexibility when installing blinds.

### Bracket Features:

- Load Capacity 4.0Kg
- Powder coated for rust resistance.
- Plastic cover caps available to finish blinds when fitted outside the recess.
- Extended base bracket aids installation while keeping slim profile shape.
- Dual roller bracket available enabling two roller blinds to be installed on the same bracket.

### Roller Tube:

- High Quality extruded aluminium 45mm triple slot tubing.

### Maximum recommended fabric sizes for blinds on 45mm roller tube system.

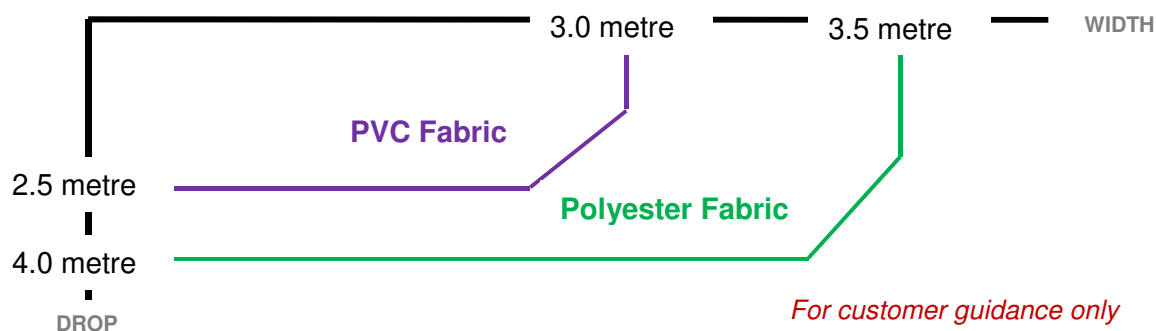

**Please note:**  
**WE FREQUENTLY MANUFACTURE MUCH LARGER ROLLER BLINDS  
 USING SPECIALISED HEAVY DUTY COMPONENTS.**





## 61 mm Sidewinder Roller Blinds

The professional quality range of sidewinder roller blinds systems that are used in all Saxon Blind's installations have been engineered to precise perfection, offering a unique balance between design, engineering and cost. Technology, insight and knowledge have been used to innovate, refine and develop a collection of reliable components ultimately suitable for any commercial applications.

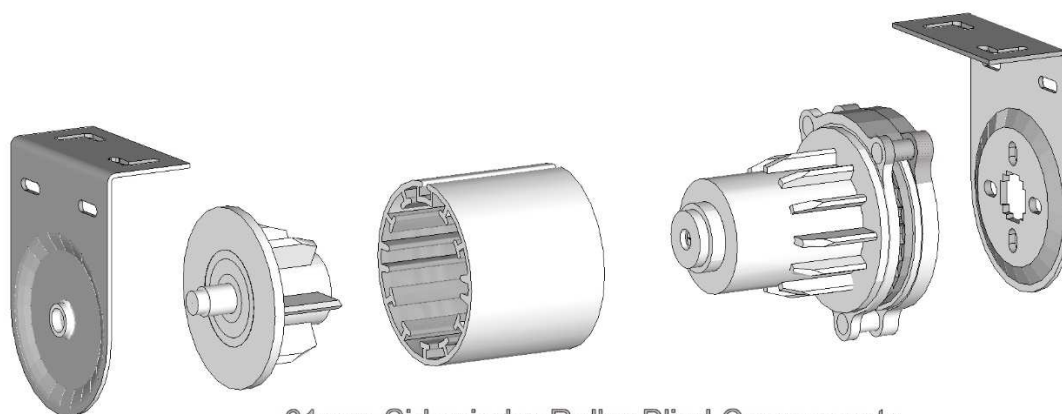

61mm Sidewinder Roller Blind Components

### Drive End Features:

- The 1:4 geared clutch ensure that this system can cope with up to 12kg of fabric.
- Operated with nickel N° 10 chain
- Internal mechanisms are coated with tailored lubricant ensuring smooth and quiet operation.
- 3 pin secure fitting clicks securely into bracket.

### Free End:

- Spring loaded plunge pin design offers flexibility when installing blinds.

### Bracket Features:

- Load Capacity 12.0Kg
- Plated for rust resistance.
- Plastic cover caps available to finish blinds when fitted outside the recess.
- Dual roller bracket available enabling two roller blinds to be installed on the same bracket.

### Roller Tube:

- High Quality 61mm internal webbed extruded aluminium single slot tubing.

### Maximum recommended fabric sizes for blinds on 61mm roller tube system.

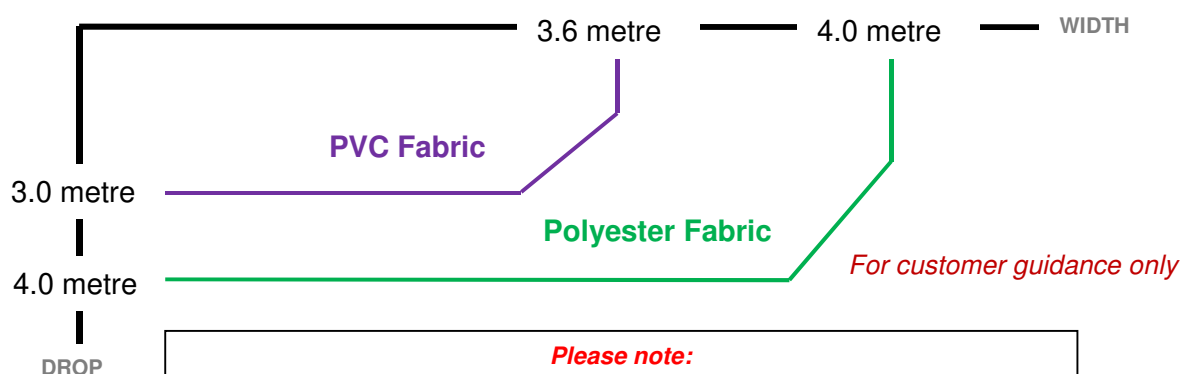



## 70 mm Sidewinder Roller Blinds

The professional quality range of sidewinder roller blinds systems that are used in all Saxon Blind's installations have been engineered to precise perfection, offering a unique balance between design, engineering and cost. Technology, insight and knowledge have been used to innovate, refine and develop a collection of reliable components ultimately suitable for any commercial applications.

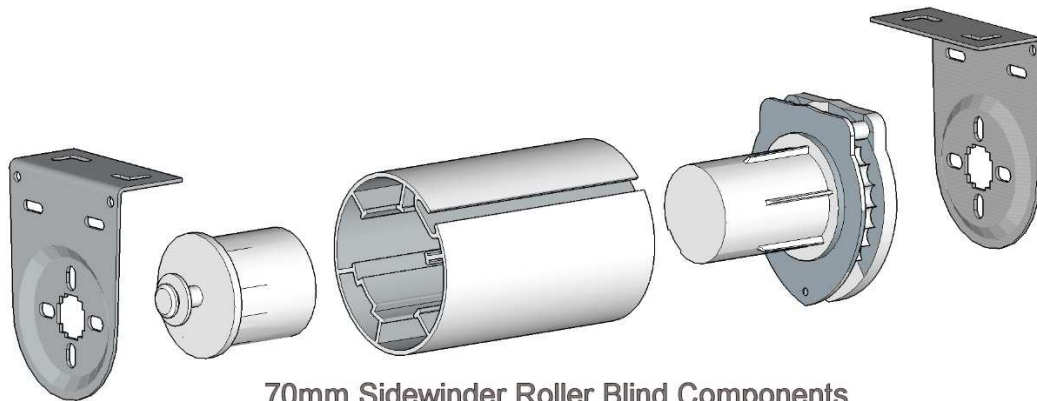

70mm Sidewinder Roller Blind Components

### Drive End Features:

- The 1:4 geared clutch ensure that this system can cope with up to 12kg of fabric.
- Operated with nickel N° 10 chain
- Internal mechanisms are coated with tailored lubricant ensuring smooth and quiet operation.
- 3 pin secure fitting clicks securely into bracket.

### Free End:

- Spring loaded plunge design offers flexibility and positive locking into bracket.

### Bracket Features:

- Universal Bracket enabling blind to be fitted for under or over hand operation.
- Load Capacity 12.0Kg
- Plated for rust resistance.
- Plastic cover caps available to finish blinds when fitted outside the recess.

### Roller Tube:

- High Quality 70mm internal webbed extruded aluminium single slot tubing.

### Maximum recommended fabric sizes for blinds on 70mm roller tube system.

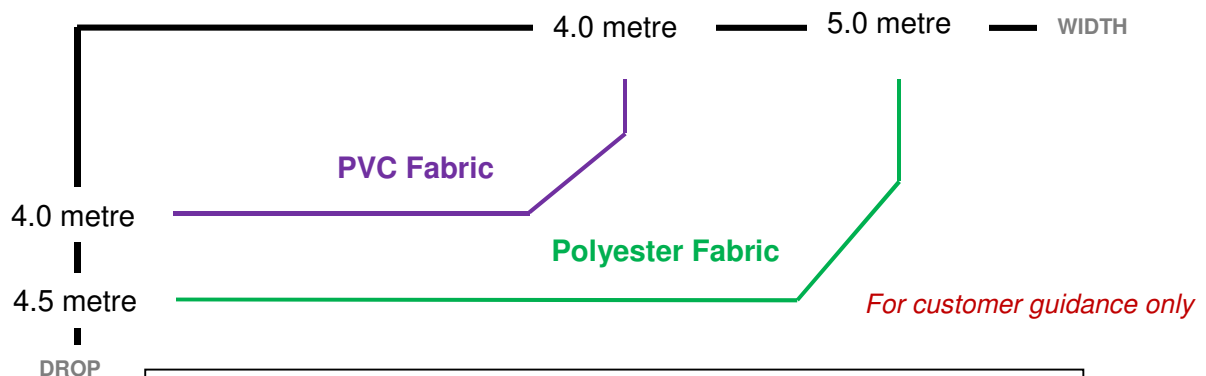

**Please note:**  
**WE FREQUENTLY MANUFACTURE MUCH LARGER ROLLER BLINDS  
 USING SPECIALISED HEAVY DUTY COMPONENTS.**





## 130 mm Motorised Roller Blinds

Top of our professional range of heavy duty roller blinds systems is the motorised Energy 473. This is a system for very large areas of glazing and is suitable for large filter curtains and shading on windows up to 6 metres wide and with a maximum drop of 8 metres.

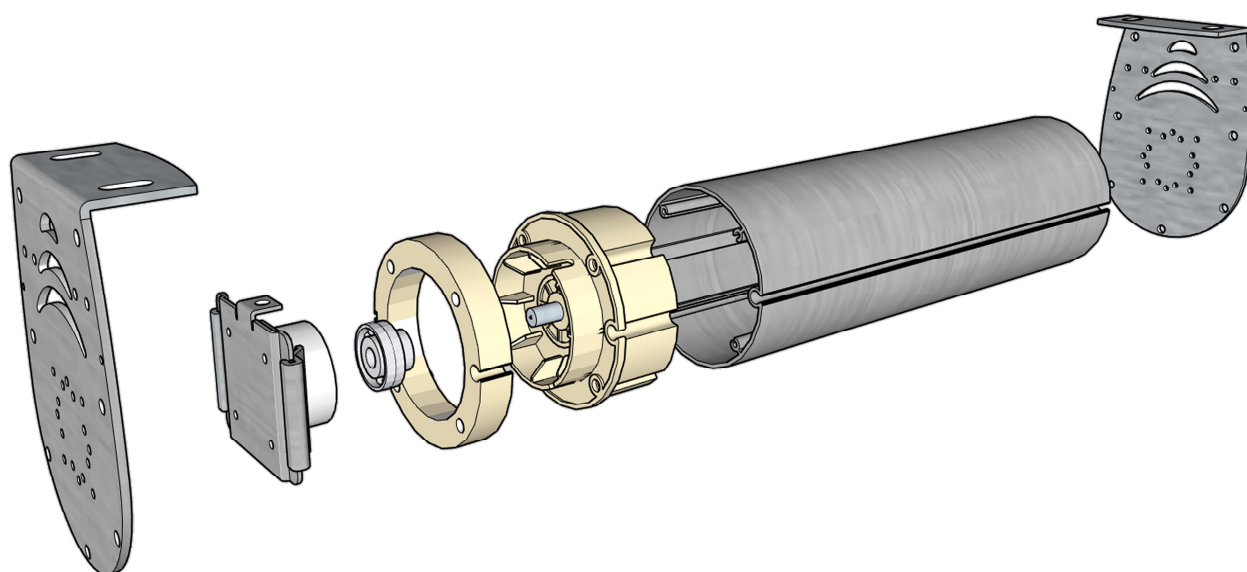

### Drive End Features:

- .230v AC 50Hz Programable Electric Motor

### Free End:

- Supported on an enclosed Ball Bearing mounting

### Bracket Features:

- Stainless Steel brackets with aesthetic covers made of impact-resistant thermoplastic and integrated adjustment of the roller tube axis.

### Roller Tube:

- High Quality 130mm internal webbed extruded aluminium dual slot tubing.

### Maximum recommended fabric sizes for blinds on 130mm roller tube system.

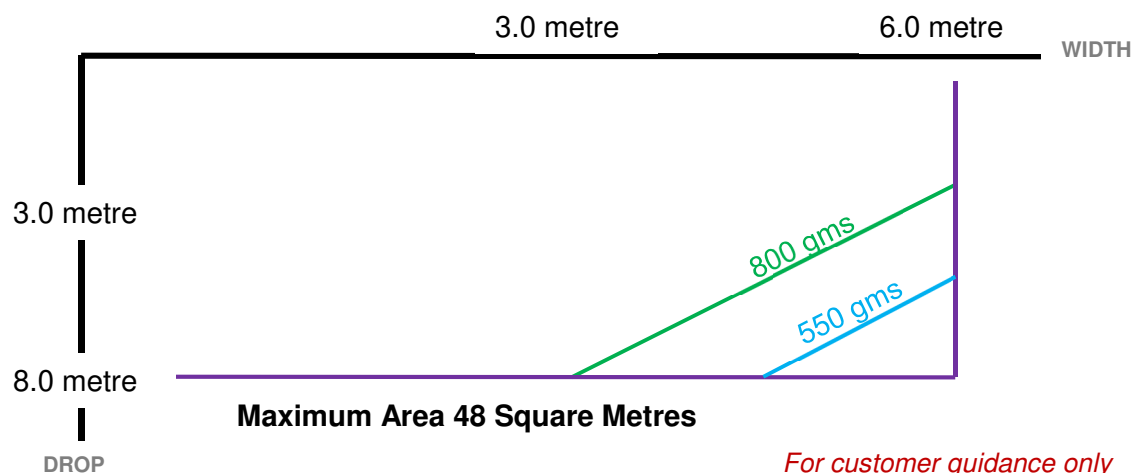



## ROLLER TUBES



61mm Dia

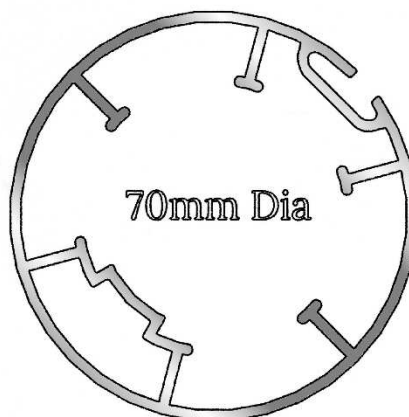

70mm Dia

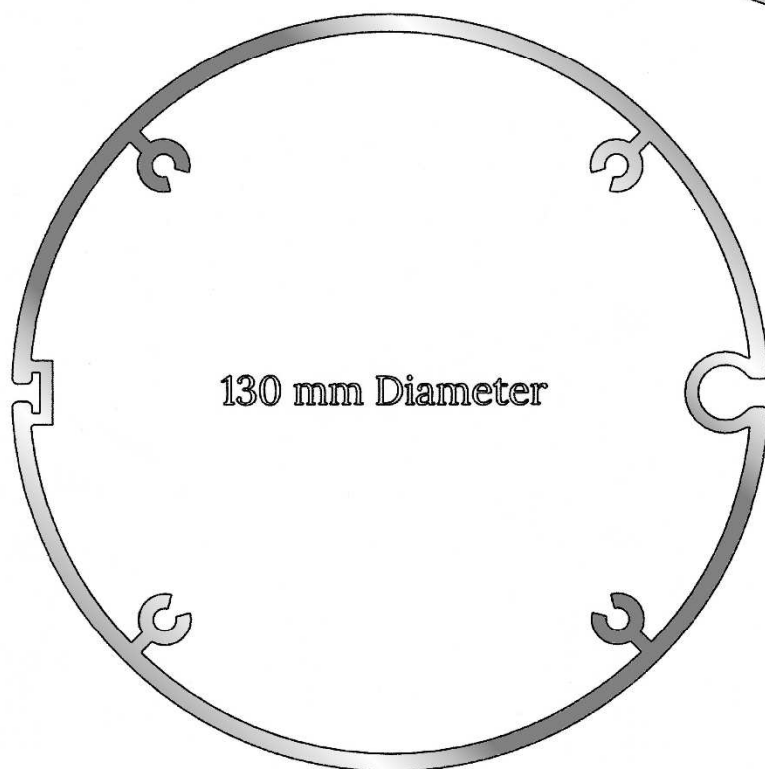

130 mm Diameter



40mm Dia



45mm Dia

## BOTTOM RAILS

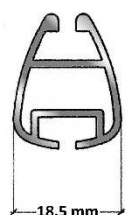

18.5 mm



22.0 mm



14.2 mm

